

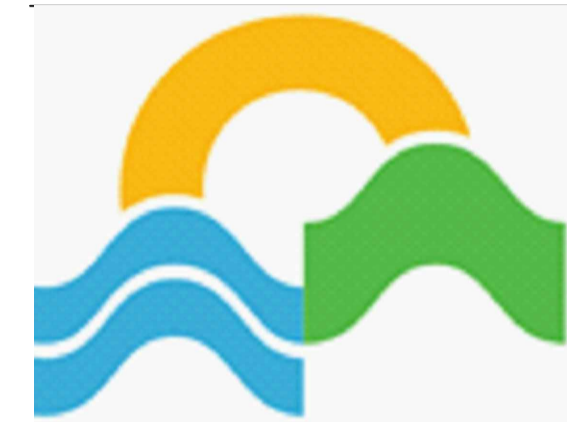

Tionscadal Éireann  
Project Ireland  
**2040**



*Comhairle Chontae Uíbh Fhailí*  
Offaly County Council

# **Proposed New road layout in the vicinity of Bury Bridge (Whitehall Bridge), Puttaghan, Tullamore, Co. Offaly**

## **PART VIII - DRAWINGS**

Tullamore Municipal District,  
Offaly County Council,  
Town Hall,  
Cormac Street,  
Tullamore,  
Co. Offaly.  
Tel: (057)9354270  
Email: [tullamoremd@offalycoco.ie](mailto:tullamoremd@offalycoco.ie)

Tom Shanahan  
Director of Services,  
Offaly County Council,  
Aras an Chontae,  
Charleville Road,  
Tullamore,  
Co. Offaly.

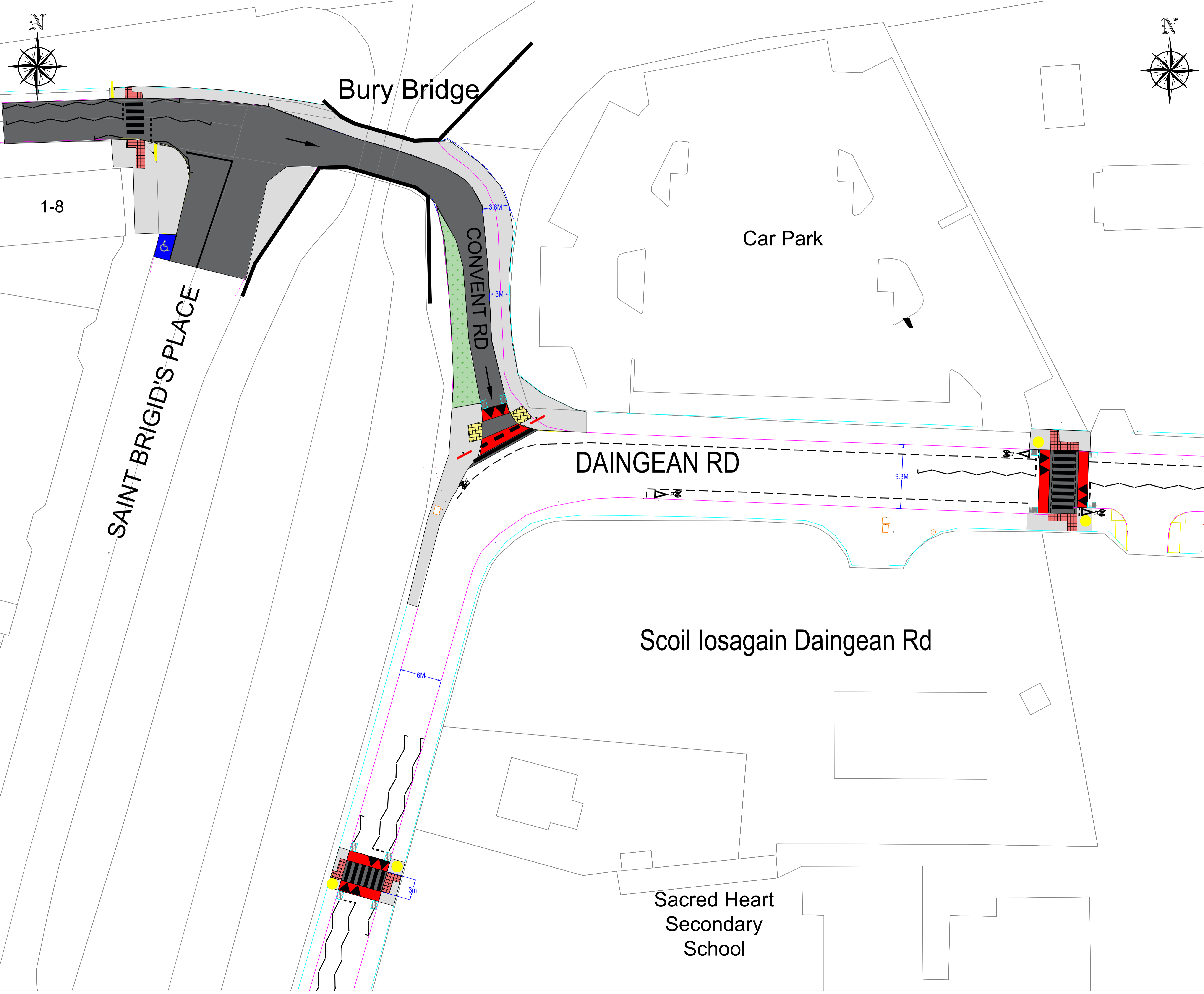

**NOTES:**

- FOOTPATH**
  - PROPOSED FOOTPATH
  - PROPOSED TACTILE RED
  - PROPOSED TACTILE BUFF
- PAVEMENT**
  - PROPOSED PAVEMENT
  - PROPOSED RAMP
  - EXISTING ROAD EDGE
  - EXISTING BOUNDARY
  - EXISTING CYCLE PATH
  - BURY BRIDGE WALL
  - GRASS VERGE
- GULLIES**
  - PROPOSED GULLY
- SIGNAGE**
  - PROPOSED PEDESTRIAN CROSSING SIGN
  - PROPOSED NO ENTRY SIGN
  - PROPOSED BELISHA BEACON

Includes Ordnance Survey Ireland data reproduced under OSI License number 2023/32/CCMA/Offaly County Council.

Unauthorized reproduction infringes Ordnance Survey Ireland and Government of Ireland copyright.  
© Ordnance Survey Ireland, 2023

|  |  |  |  |
|--|--|--|--|
|  |  |  |  |
|  |  |  |  |
|  |  |  |  |
|  |  |  |  |

| DESCRIPTION | DATE | INT. | REV. |
|-------------|------|------|------|
|-------------|------|------|------|



**Offaly County Council**  
Tel. (057) 9346800

Mr. Tom Shanahan, CEng, F.I.E.I.  
Director of Services,  
Aras an Chontae,  
Tullamore, Co., Offaly.

**PROJECT**  
Proposed Part 8 Development: Proposed New road layout in the vicinity of Bury Bridge (Whitehall Bridge), Puttaghan, Tullamore, Co. Offaly

**TITLE**  
Proposed Layout Plan

|                              |  |                                       |
|------------------------------|--|---------------------------------------|
| <b>SCALES</b><br>1:250<br>@1 | <b>ROAD NO</b><br>L-2025-5,<br>L2023-1 | <b>DRAWING NO</b><br>OY/24/PAV/002/01 |
|                              | <b>DATE</b><br>JUL 2024                | <b>DRAWN BY</b><br>P.E.               |
|                              |  | <b>CHECKED</b><br>J.C.                |



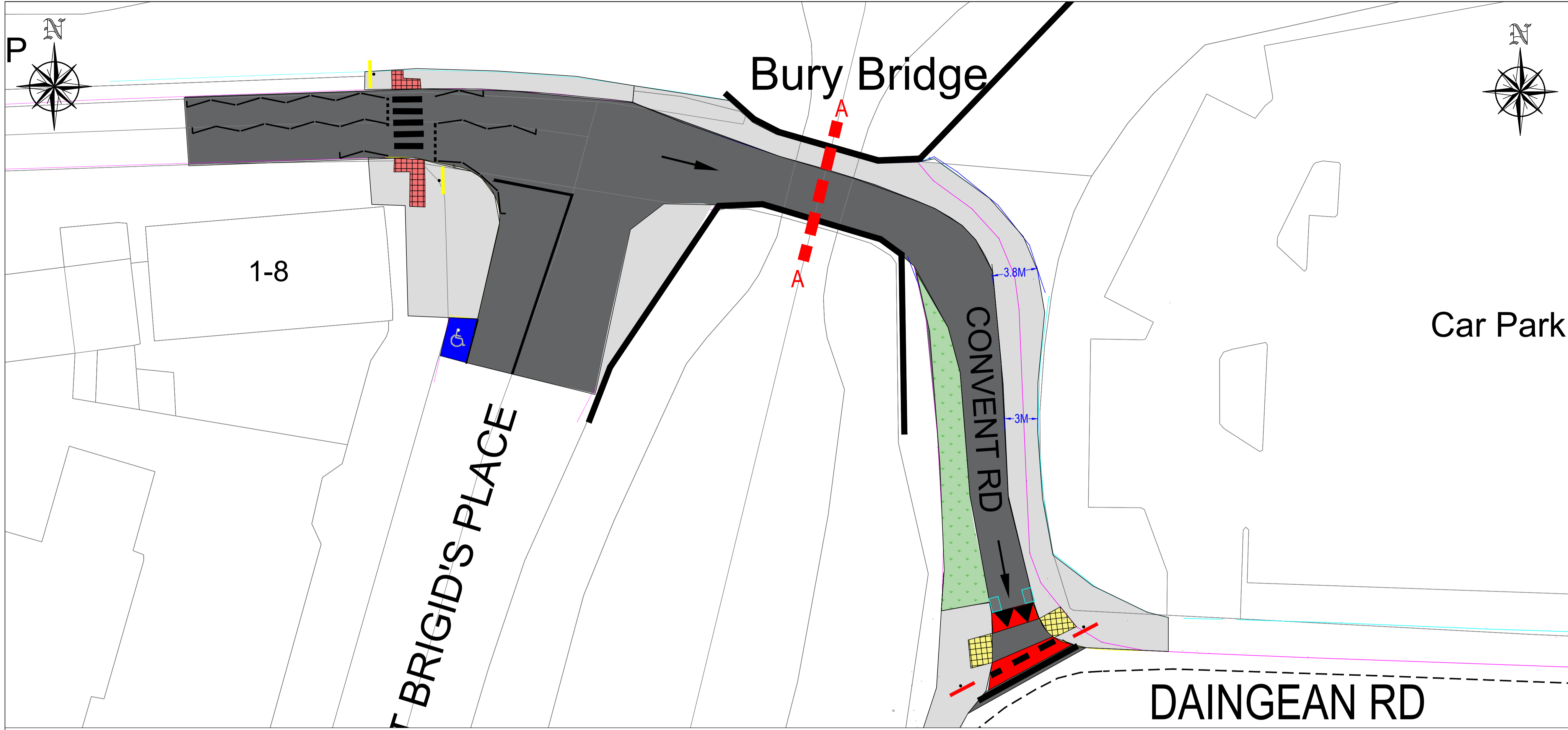

- NOTES:**
- FOOTPATH**
- PROPOSED FOOTPATH
  - PROPOSED TACTILE RED
  - PROPOSED TACTILE BUFF
- PAVEMENT**
- PROPOSED PAVEMENT
  - PROPOSED RAMP
  - EXISTING ROAD EDGE
  - EXISTING BOUNDARY
  - EXISTING CYCLE PATH
  - BURY BRIDGE WALL
  - GRASS VERGE
- GULLIES**
- PROPOSED GULLY
- SIGNAGE**
- PROPOSED PEDESTRIAN CROSSING SIGN
  - PROPOSED NO ENTRY SIGN
  - PROPOSED BELISHA BEACON

Includes Ordnance Survey Ireland data reproduced under OSI License number 2023/32/CCMA/Offaly County Council.

Unauthorized reproduction infringes Ordnance Survey Ireland and Government of Ireland copyright.  
© Ordnance Survey Ireland, 2023

| DESCRIPTION | DATE | INT. | REV. |
|-------------|------|------|------|
|             |      |      |      |
|             |      |      |      |
|             |      |      |      |
|             |      |      |      |

DESCRIPTION DATE INT. REV.



Mr. Tom Shanahan, CEng, F.I.E.I.  
Director of Services,  
Aras an Chontae,  
Tullamore, Co., Offaly.

**PROJECT**  
Proposed Part 8 Development: Proposed New road layout in the vicinity of Bury Bridge (Whitehall Bridge), Puttaghan, Tullamore, Co. Offaly

**TITLE**  
Cross section of Bury Bridge

| SCALES | ROAD NO              | DRAWING NO       |
|--------|----------------------|------------------|
| NTS    | L-2025-5,<br>L2023-1 | OY/24/PAV/002/02 |
|        | DATE                 | DRAWN BY         |
|        | JUL 2024             | P.E.             |
|        |                      | CHECKED          |
|        |                      | J.C.             |

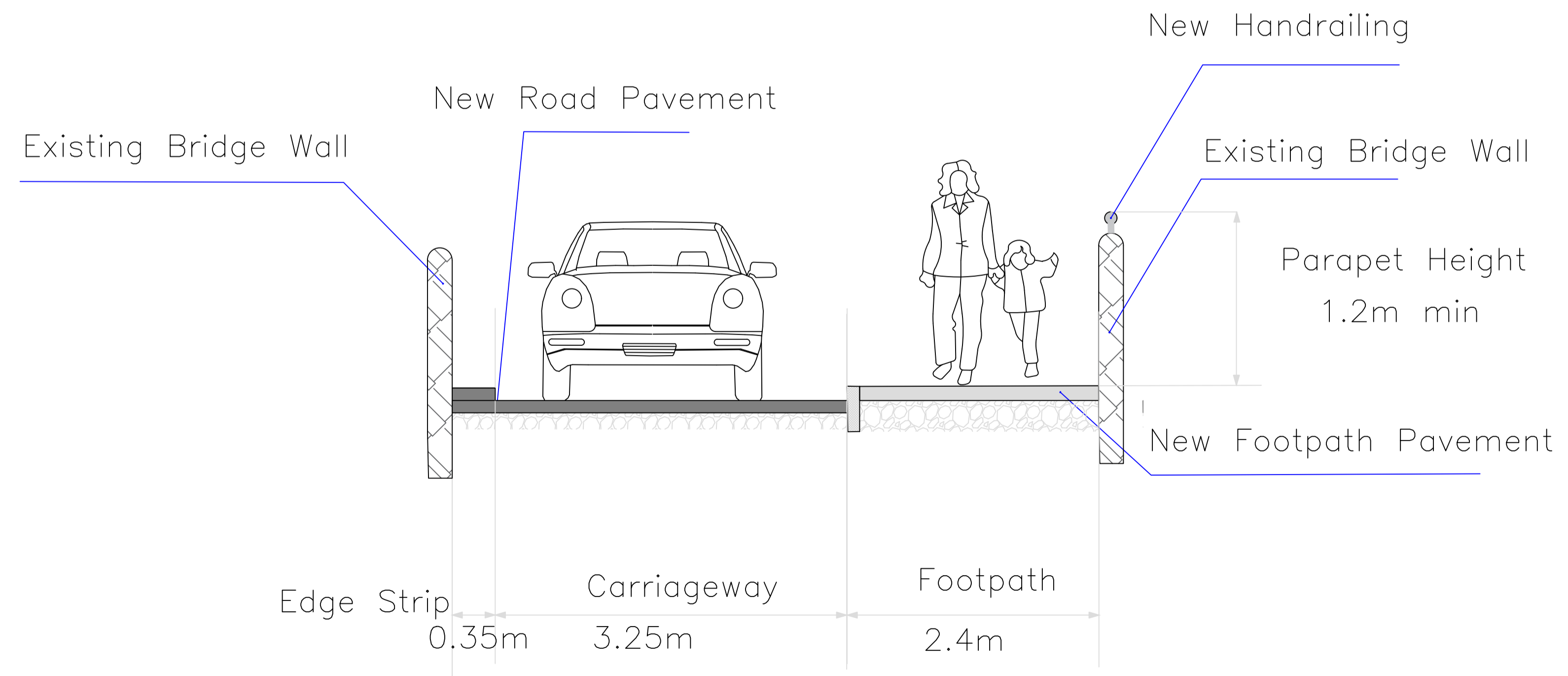

**CROSS SECTION (A-A)**