

CHAPTER 8 - ROAD LEVEL 2(i) 80km/h

Design Parameters	TYPE A >12 hours	TYPE B <12 hours	TYPE C <15 mins
Advance Warning Signs			
Sign Size (mm)	600	600	-
Sign Visibility (m)	90	90	90
No. of Signs	4	3	-
Cumulative Distance (m)	480	360	-
Distance between Advance Warning Signs (m)	120	120	-
Taper			
Lane Taper Rate	1 in 40	1 in 40	-
Hard Shoulder Taper Rate	-	-	-
Cones			
Cone Height (mm)	750	750	-
Taper Spacing (m)	3	3	-
Longitudinal Spacing (m)	12	12	-
Lamps (unlit areas only)			
Taper Spacing (m)	6	6	-
Longitudinal Spacing (m)	24	24	-
Safety Zones			
Longitudinal (m)	45	45	-
Lateral (m)	1.2	1.2	-
Lanes (minimum)			
Lane Width (m)	3	3	-

REV:	DESCRIPTION:	BY:	DATE:

KEY:

- ROAD CONE
- ← SIGN MARKER
- WORKS AREA
- LONGITUDINAL SAFETY ZONE
- LATERAL SAFETY ZONE

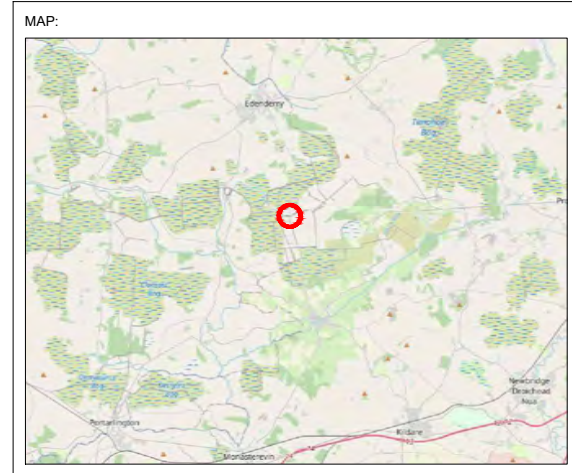

© greenlight-tm Traffic Management Design & Consultancy



NOTES:

- A) ALL INFORMATION CONTAINED IN THIS TTM DRAWING SHOULD BE CHECKED AGAINST THE EXISTING ROAD GEOMETRY TO ENSURE THAT THIS TRAFFIC MANAGEMENT DRAWING IS AS PER CURRENT CONDITIONS.
- B) THE TEMPORARY TRAFFIC MANAGEMENT CONTRACTOR IS REQUIRED TO HAVE CARRIED OUT A DYNAMIC ON-SITE RISK ASSESSMENT PRIOR TO THE INSTALLATION OF THIS TTM DRAWING TO ENSURE THAT THE CONDITIONS REFLECT THOSE CONSIDERED FOR THE DESIGN.
- C) ALL TTM WORKS ARE TO BE CARRIED OUT IN ACCORDANCE WITH GOVERNING BODY AND LOCAL AUTHORITY REQUIREMENTS AND BE INCLUDED IN THE SAFETY & HEALTH PLAN
- D) THIS TTM DRAWING HAS BEEN DRAFTED AS PER THE PARAMETERS SET OUT IN DTTAS CHAPTER 8 OF THE TRAFFIC SIGNS MANUAL TEMPORARY TRAFFIC MEASURES AND SIGNS FOR ROADWORKS 2019 FOR LEVEL 1 ROADS ONLY. AND AS SUCH IS NOT INTENDED TO BE USED ON ANY OTHER CLASSIFICATION OF ROAD.
- E) THIS SITE SPECIFIC TRAFFIC MANAGEMENT DRAWING APPLIES ONLY TO THE LOCATION, PROJECT TYPE AND GEOMETRY OF THE ROAD OF WHICH IS SPECIFIED.
- F) ANY REPRODUCTION OR COPYING OF THIS DOCUMENT IS PROHIBITED.
- G) THIS TTM DRAWING IS ONLY TO BE INSTALLED WHEN TRAFFIC COUNTS HAVE BEEN TAKEN AND RESULT IN THE APPROPRIATE LIMITS SET OUT IN DTTAS CHAPTER 8.
- H) THE TTM DESIGNER ACCEPTS NO RESPONSIBILITY FOR THE RESULTS WHERE CHAPTER 8, TTM DESIGN GUIDANCE AND TTM OPERATION GUIDANCE HAVE NOT BEEN ADHERED TO IN THEIR ENTIRETY.
- I) ANY ALTERATION OTHER THAN BY THE TTM DESIGNER RENDERS THIS TTM DRAWING AND INFORMATION HEREIN VOID.

PROJECT: **HIGHWAY MAINTENANCE**

TITLE: **ROAD CLOSURE & DETOUR L3001**

SCALE AT A3: NTS	DATE: 22/03/2023	DRAWN: SJ	CHECKED: NW
DRAWING NO: D007-107-002a			REVISION: 0

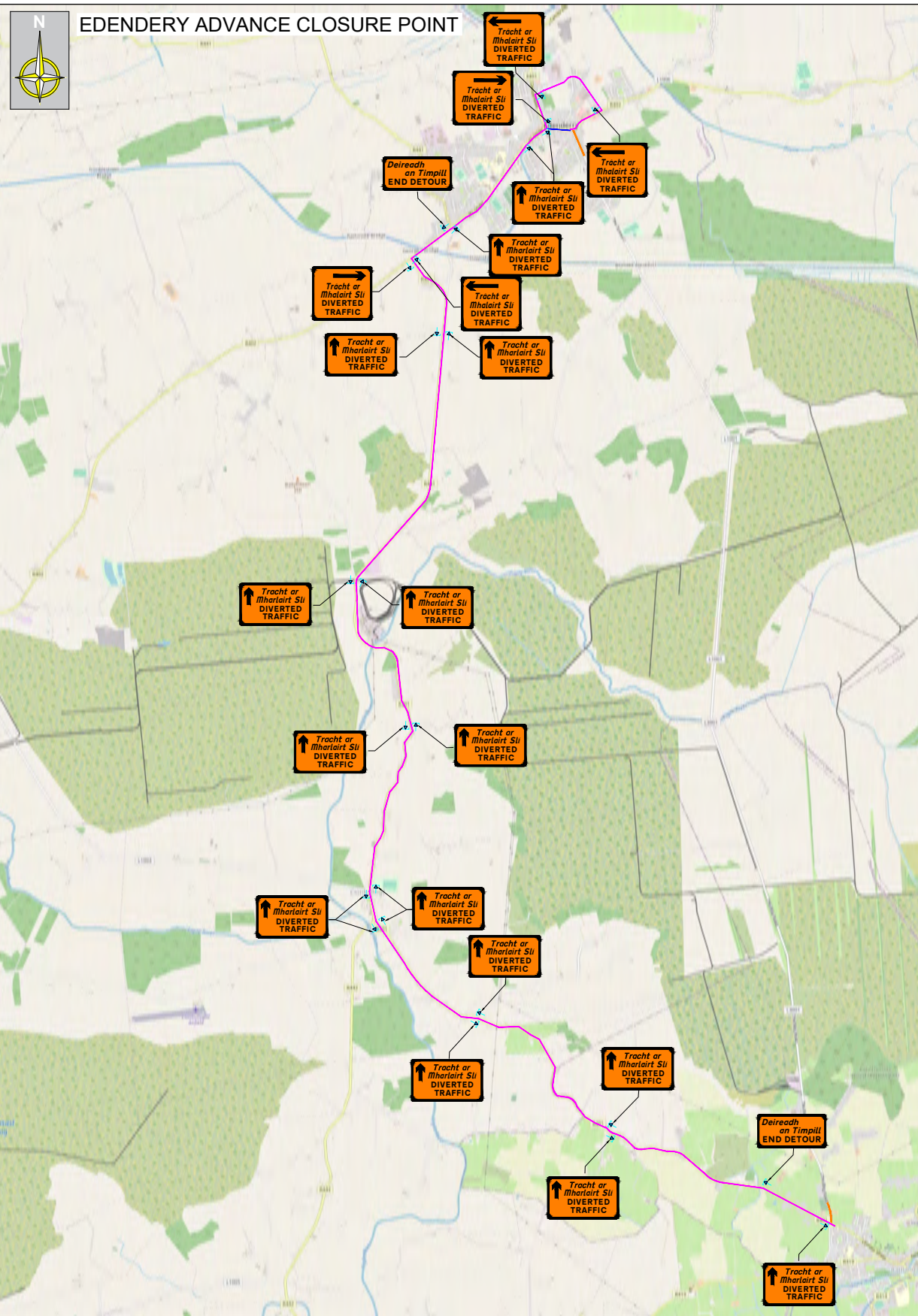

SITE SPECIFIC NOTE:

- ROAD CLOSURE & DETOUR OF L3001
- LOCAL ACCESS TO BE MAINTAINED BY USE OF TRAFFIC MASHALLS AT BOTH CLOSURE POINTS
- ADJOINING SIDE ROAD DETAIL TO BE INSTALLED AT MAIN ROAD JUNCTIONS WITHIN THE ADVANCE ROAD CLOSURE POINTS
- TRAFFIC APPROACHING THE ROAD CLOSURE POINTS IS TO BE TURNED TO RETURN THE WAY THEY APPROACHED FROM AND ADVISED TO JOIN THE DETOUR ROUTES
- THE DETOUR ROUTE IS A MINIMUM OF REGIONAL ROAD FOR THE ENTIRE LENGTH

ADJOINING SIDE ROAD DETAIL

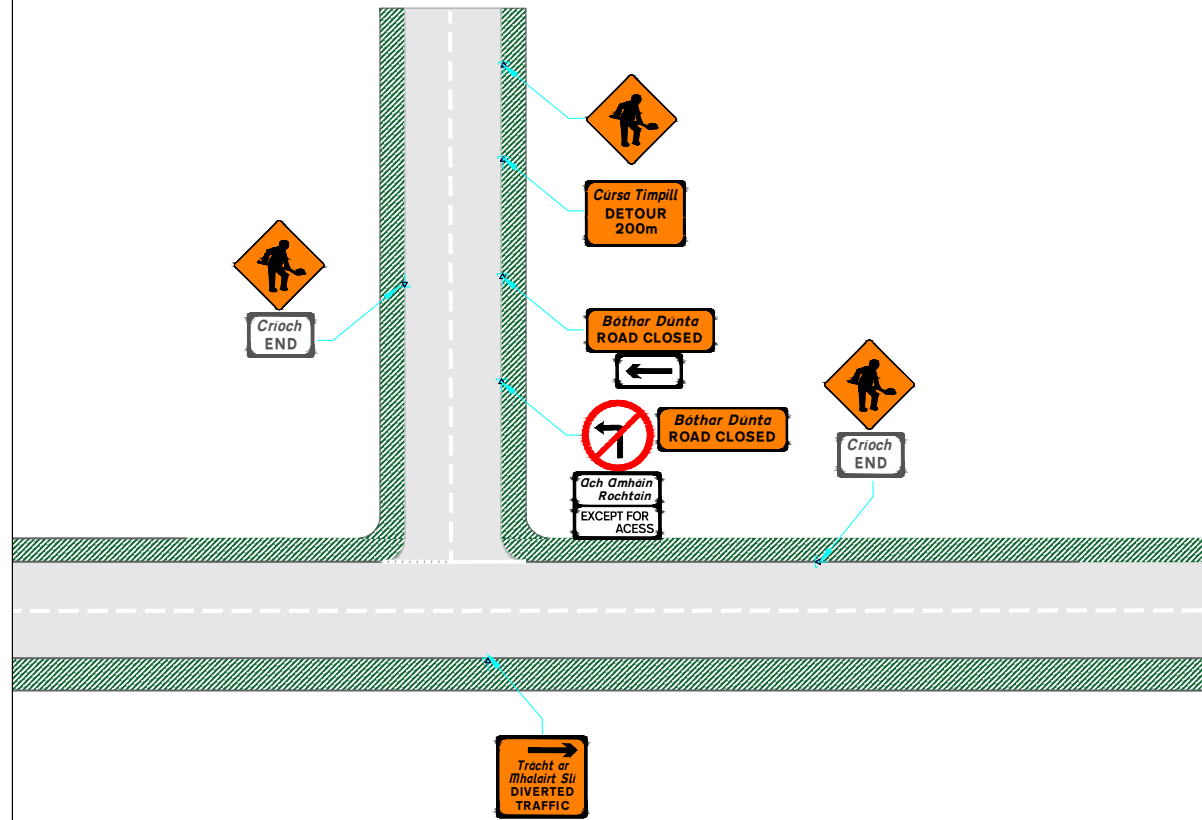

CHAPTER 8 - ROAD LEVEL 2(i) 80km/h			
Design Parameters	TYPE A >12 hours	TYPE B <12 hours	TYPE C <15 mins
Advance Warning Signs			
Sign Size (mm)	600	600	-
Sign Visibility (m)	90	90	90
No. of Signs	4	3	-
Cumulative Distance (m)	480	360	-
Distance between Advance Warning Signs (m)	120	120	-
Taper			
Lane Taper Rate	1 in 40	1 in 40	-
Hard Shoulder Taper Rate			
Cones			
Cone Height (mm)	750	750	-
Taper Spacing (m)	3	3	-
Longitudinal Spacing (m)	12	12	-
Lamps (unlit areas only)			
Taper Spacing (m)	6	6	-
Longitudinal Spacing (m)	24	24	-
Safety Zones			
Longitudinal (m)	45	45	-
Lateral (m)	1.2	1.2	-
Lanes (minimum)			
Lane Width (m)	3	3	-

REV:	DESCRIPTION:	BY:	DATE:
------	--------------	-----	-------

- KEY:**
- ROAD CONE
 - ⚡ SIGN MARKER
 - ▨ WORKS AREA
 - ▨ LONGITUDINAL SAFETY ZONE
 - ▨ LATERAL SAFETY ZONE

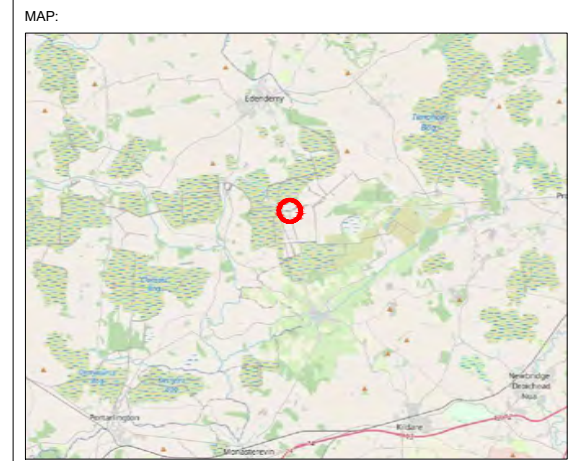

PROJECT: HIGHWAY MAINTENANCE			
TITLE: ROAD CLOSURE & DETOUR L3001			
SCALE AT A3: NTS	DATE: 22/03/2023	DRAWN: SJ	CHECKED: NW
DRAWING NO: D007-107-002b			REVISION: 0

© greenlight-tm Traffic Management Design & Consultancy



NOTES:

- ALL INFORMATION CONTAINED IN THIS TTM DRAWING SHOULD BE CHECKED AGAINST THE EXISTING ROAD GEOMETRY TO ENSURE THAT THIS TRAFFIC MANAGEMENT DRAWING IS AS PER CURRENT CONDITIONS.
- THE TEMPORARY TRAFFIC MANAGEMENT CONTRACTOR IS REQUIRED TO HAVE CARRIED OUT A DYNAMIC ON-SITE RISK ASSESSMENT PRIOR TO THE INSTALLATION OF THIS TTM DRAWING TO ENSURE THAT THE CONDITIONS REFLECT THOSE CONSIDERED FOR THE DESIGN.
- ALL TTM WORKS ARE TO BE CARRIED OUT IN ACCORDANCE WITH GOVERNING BODY AND LOCAL AUTHORITY REQUIREMENTS AND BE INCLUDED IN THE SAFETY & HEALTH PLAN
- THIS TTM DRAWING HAS BEEN DRAFTED AS PER THE PARAMETERS SET OUT IN DTTAS CHAPTER 8 OF THE TRAFFIC SIGNS MANUAL TEMPORARY TRAFFIC MEASURES AND SIGNS FOR ROADWORKS 2019 FOR LEVEL 1 ROADS ONLY. AND AS SUCH IS NOT INTENDED TO BE USED ON ANY OTHER CLASSIFICATION OF ROAD.
- THIS SITE SPECIFIC TRAFFIC MANAGEMENT DRAWING APPLIES ONLY TO THE LOCATION, PROJECT TYPE AND GEOMETRY OF THE ROAD OF WHICH IS SPECIFIED.
- ANY REPRODUCTION OR COPYING OF THIS DOCUMENT IS PROHIBITED.
- THIS TTM DRAWING IS ONLY TO BE INSTALLED WHEN TRAFFIC COUNTS HAVE BEEN TAKEN AND RESULT IN THE APPROPRIATE LIMITS SET OUT IN DTTAS CHAPTER 8.
- THE TTM DESIGNER ACCEPTS NO RESPONSIBILITY FOR THE RESULTS WHERE CHAPTER 8, TTM DESIGN GUIDANCE AND TTM OPERATION GUIDANCE HAVE NOT BEEN ADHERED TO IN THEIR ENTIRETY.
- ANY ALTERATION OTHER THAN BY THE TTM DESIGNER RENDERS THIS TTM DRAWING AND INFORMATION HEREIN VOID.