



28.2.22.



Dear Sir/ Madam,

I enclose maps of land near Portarlinton which I wish to have zoned for residential development.

As is clear from the map this land is beside land which is already developed and has easy access to all services including water ,sewage and electricity.

There are 3 hectares in this piece of land in Co. Offaly while the rest of the field 1.3 hectares is in Co. Laois.

This is an ideal location for housing and should be seriously considered when Zoning is being carried out later this year.

Yours Sincerely,

Paul Mitchell

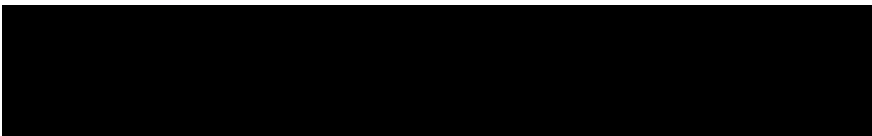

Property Details

File Number	OY18049
Title Level	Freehold
Plan Number	11
Property Number	2
Area of selected plans	3.01 hectares
Number of Plans on this folio:	2
Address	Not Available

[Add to Basket](#) [Create Alert](#)

Area Boundaries and Plan Area are not conclusive. See Section 62(1)(a) of the Land Registration Rules 2011.

[View Basket](#)
[Print Current View](#)
[Help](#)

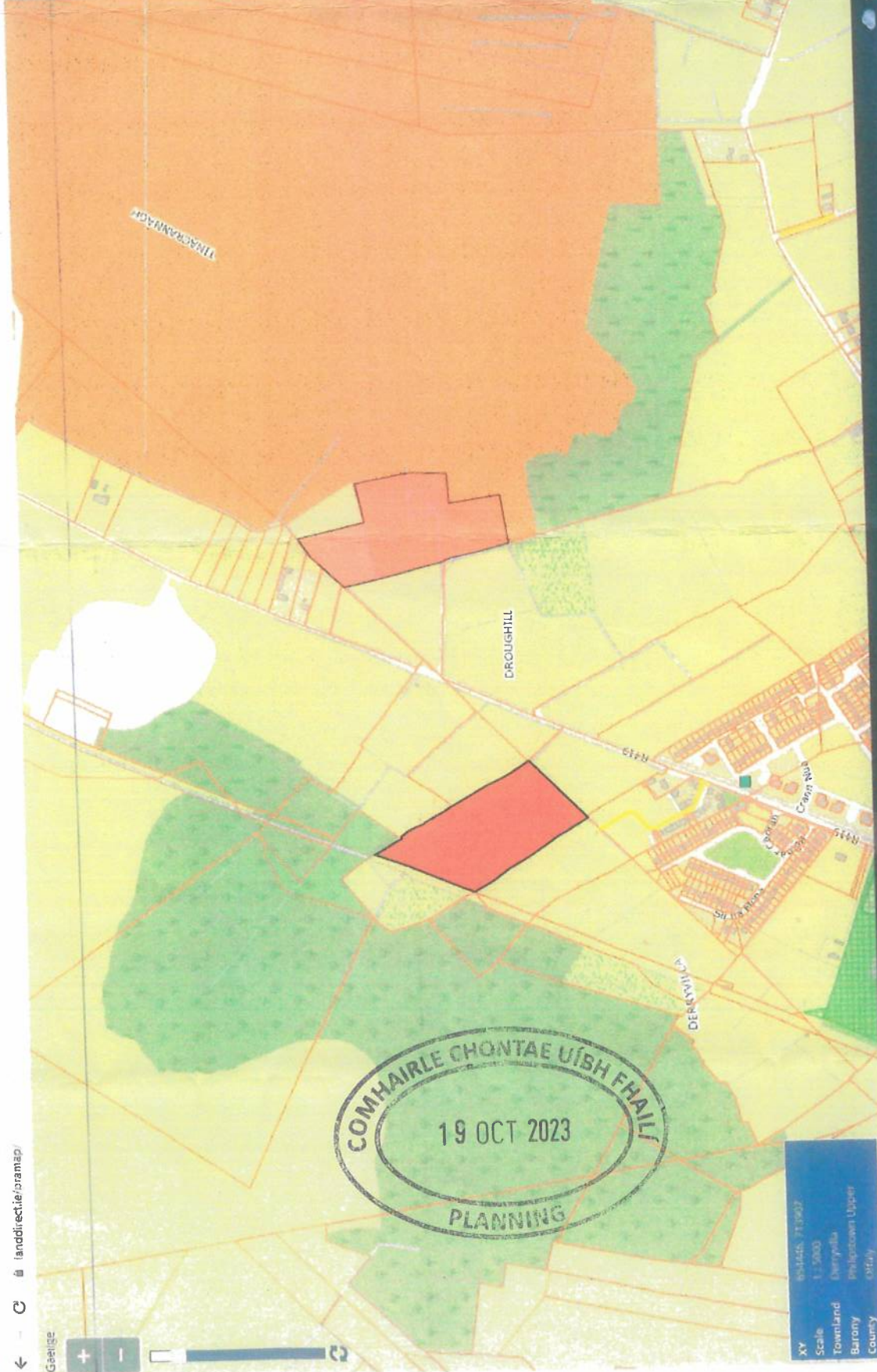

XY: 69445, 71362
Scale: 1:5000
Townland: Berrysella
Barony: Philipstown Upper
County: Wick

Type here to search

The Property
Registration Authority
An tÚdarás
Cláirúcháin Maolne
Folio: OY18949



This map should be read in conjunction with the folio.

Registry maps are based on OSI topographic mapping. Where registry maps are printed at a scale that is larger than the OSI published scale, accuracy is limited to that of the original OSI map scale.

For details of the terms of use and limitations as to scale, accuracy and other conditions relating to Land Registry maps, see www.landireg.ie.

This map incorporates Ordnance Survey Ireland (OS) mapping data under a licence from OSI. Copyright © OSI and Government of Ireland.

(centre-line of parcel(s) edged)

- Freehold
- Leasehold
- SubLeasehold

Burdens (may not all be represented on map)

- Right of Way / Wayleave
- Turbary
- Pipeline
- Well
- Pump
- Septic Tank
- Soak Pit

A full list of burdens and their symbology can be found at: www.landireg.ie

The registry operates a non-conclusive boundary system. The Registry Map identifies properties not boundaries meaning neither the description of land in a register nor its identification by reference to a registry map is conclusive as to the boundaries or extent. (see Section 85 of the Registration of Title Act, 1964). As inserted by Section 62 of the Registration of Deed and Title Act 2006.

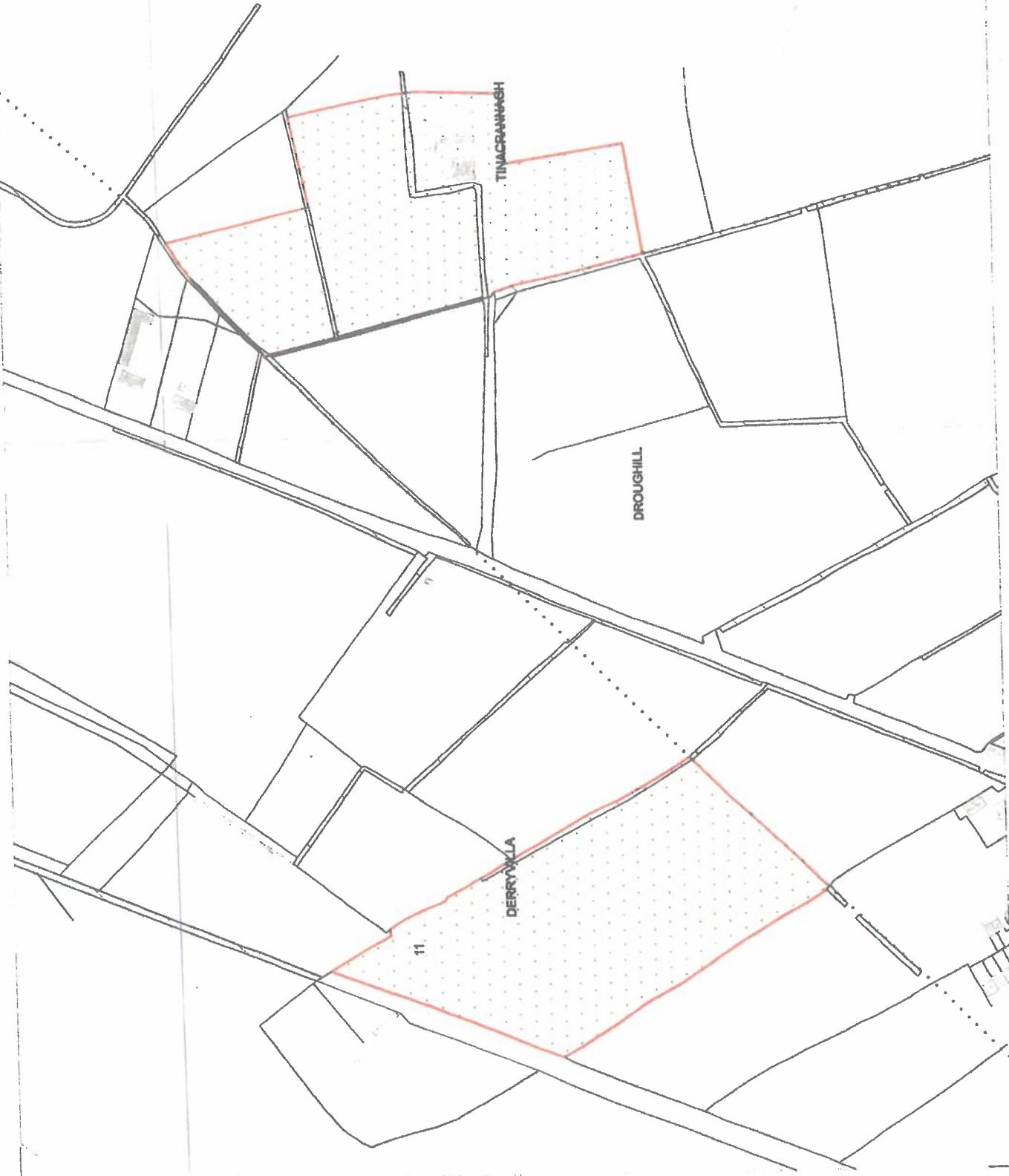

1:2500 Scale

